

# Variable transformer ESS 9013



## Advantages

- Stepless adjustment of the AC voltage from zero to the maximum value
- Self-cleaning of the exposed contact tracks
- 4-point flange mounting
- Rotary knobs and scales optionally available

## Applications

Variable auto transformer for continuous adjustment of AC voltages or currents under load.

## Sample application

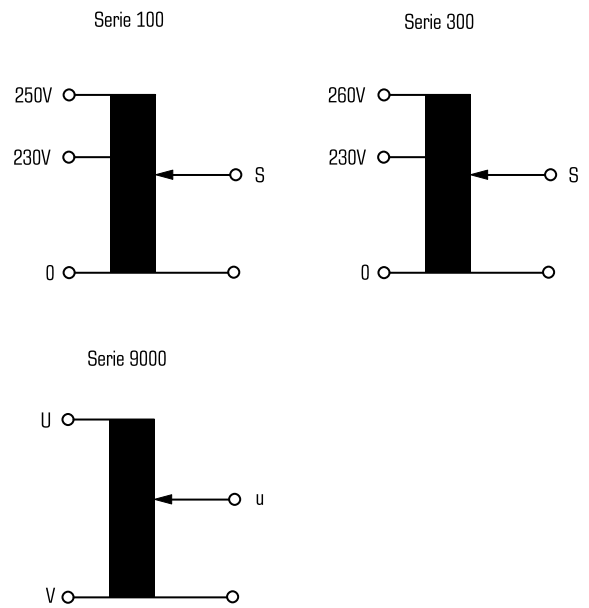

## Standards

Variable transformer  
to: VDE 0552

## Approvals





## Variable transformer ESS 9013

Type		ESS 9013
Electrical data	Input	
	Rated frequency	50 - 60 Hz
	Rated input voltage	230 Vac
	Output	
	Angle of rotation	320 °
	Rated output voltage	0...230 Vac
	Rated output current	1.25 A
	Environment	
	Ambient temperature max.	113.0 °F
	Safety and protection	
Insulation class	B	
Protection index	IP 00	
Test voltage control spindle	4 kV	
Order numbers		
Order Number		ESS 9013

Type		ESS 9013
Mechanical data	Terminal and mounting	
	Fixing method	Fixing hole
	Terminals	Screw-type terminals
	Measures and weights	
	Weight	3.09 lbs
	Accessory	
	Rotary knob (optional)	AZ 50/6-1
	Scale (optional)	SK/120
	Dimensions in inch	

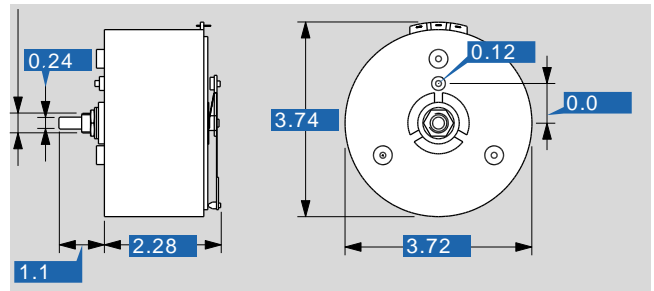

Subject to change.